

GPS

Panel Mount Antenna



GPSP

Excellent performance

Active GPS element

Single hole fixing

Knowing the position of a vehicle is vital for fleet management and logistics planning. With the GPSP panel antenna, you can identify the position of a vehicle whenever you want.

Mounted on the roof of a vehicle, the GPSP antenna's low profile design reduces the risk of damage whilst achieving optimum performance.

The antenna is fitted with a 30cm coaxial cable for ease of installation and extension cables are available to suit all GPS applications.

Technical Drawing

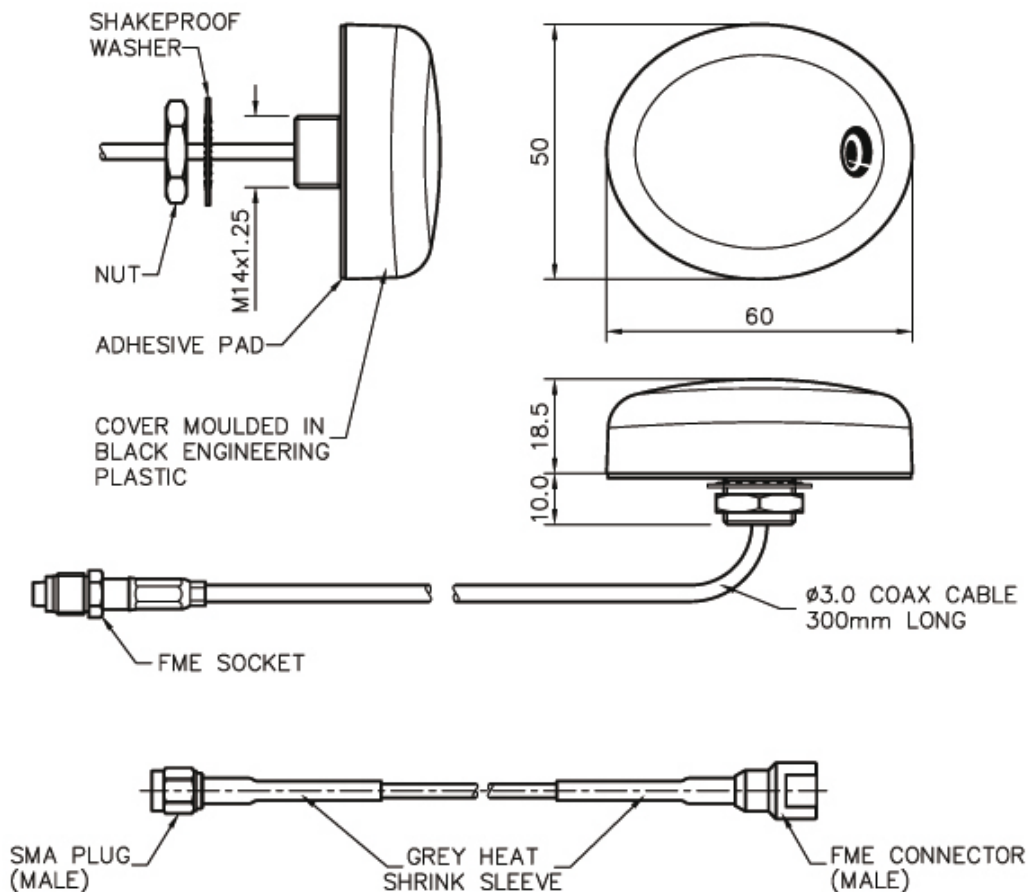

E-Plane (GPS)

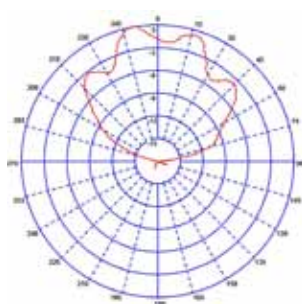

Part No.		GPSP-6SP
Electrical Data		
Frequency Range (MHz)		1575
VSWR		<2.0:1 @ 1575MHz \pm 4MHz
LNA Gain		26dB
Polarisation		Right Hand Circular
Operating Voltage		3 - 7V DC (fed via coax)
Current (Typical)		14mA
Impedance		50 Ω
Mechanical Data		
Dimensions (mm)	Length	60
	Height	18.5
	Width	50
Operating Temp ($^{\circ}$ C)		-40 $^{\circ}$ / +80 $^{\circ}$ C
Material		Engineering plastic
Colour		Black
Mounting Data		
Fixing		Panel mount
Hole Diameter (mm)		15
Hole Depth (mm)		8
Termination Data		
Type		RG174
Thickness (mm)		3
Length (m)		6
Termination		SMA Plug†

Panorama Antennas Ltd
Frogmore, London, SW18 1HF, United Kingdom

T: +44 (0)20 8877 4444
F: +44 (0)20 8877 4477

E: sales@panorama-antennas.com
www.panorama-antennas.com

PANORAMA  ANTENNAS