

1

2

3

4

5

A

B

C

D

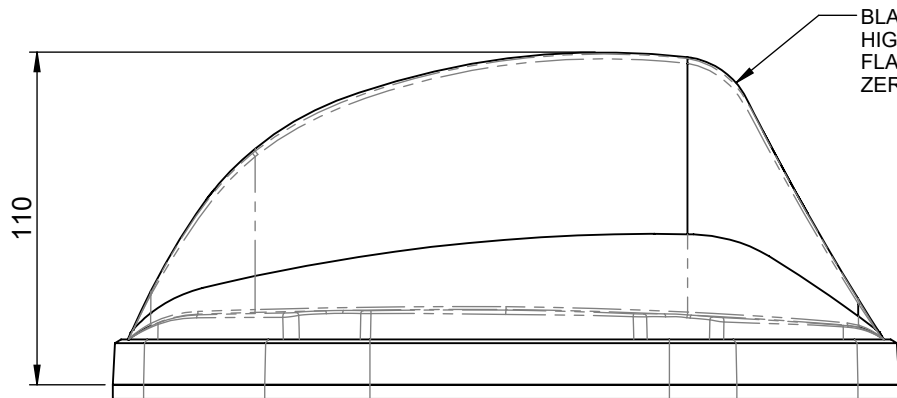

TNC SOCKET  
GPS/GNSS  
SURGE  
PROTECTION.  
PROTECTIVE CAP  
SUPPLIED.

N-TYPE SOCKET DC GROUNDED.  
PROTECTIVE CAP SUPPLIED.

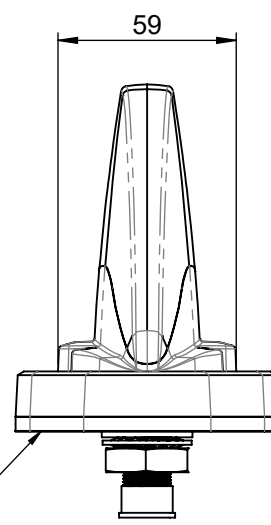
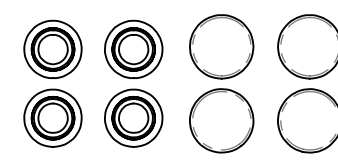
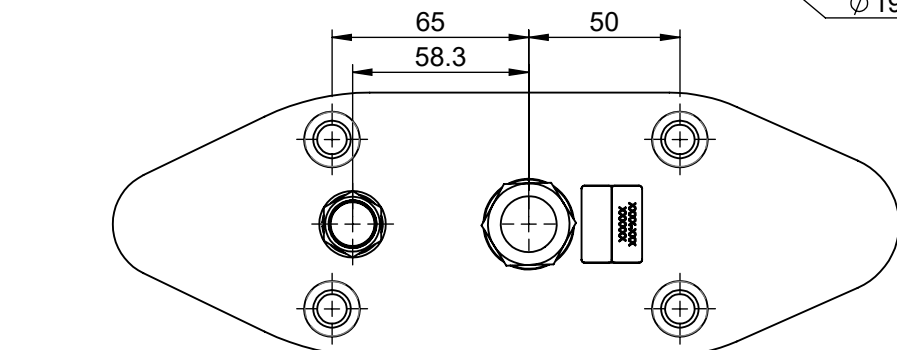
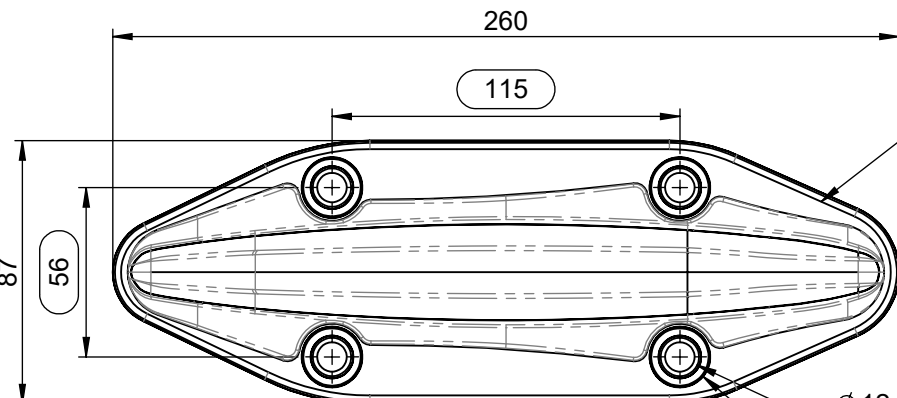

- NOTES:
- SAMPLES MUST BE APPROVED BY PANORAMA ANTENNAS Q.C. BEFORE COMMENCING PRODUCTION.
  - ALL MATERIALS SUPPLIED MUST BE RoHS2 (DIRECTIVE 2011/65/EU) COMPLIANT AND MUST NOT CONTAIN ANY SUBSTANCES OF VERY HIGH CONCERN (SVHCs) LISTED UNDER REACH OR POLY-AROMATIC HYDROCARBONS (PAHs), OR PERSISTENT ORGANIC POLLUTANTS (POPs) CONTROLLED BY THE STOCKHOLM CONVENTION.

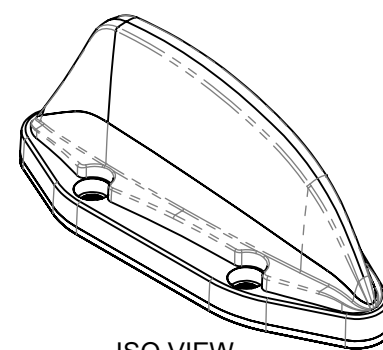

DRG. No.	TRNCG-S4			SHEET 1 OF 1
PRODUCT/ASSEMBLY	TRANSIT ANTENNA			
DESCRIPTION	TRAIN ANTENNA 450-470MHz + GPS/GNSS			
MATERIAL	N/A			
FINISH	N/A			
WEIGHT	6197.92g			
APPROVED	KD	DO.CHECK	MM	
SCALE	1:2.5	DIMENSIONS IN mm		
DO NOT SCALE	3RD ANGLE PROJECTION			
01019	A	INITIAL ISSUE	21/02/2017	AR
01019	1	PRODUCTION ISSUE (UPDATED INTERNALS)	20/02/2018	AR
PCN	REV.	DESCRIPTION	DATE	DRN
TOLERANCES UNLESS OTHERWISE STATED				
0 DEC. PLACE	±0.5	2 DEC. PLACES	±0.1	
1 DEC. PLACE	±0.2	ANGULAR	±1°	
	DENOTES LATEST ISSUE CHANGES			DENOTES CRITICAL VALUE
THIS DOCUMENT MUST NOT BE COPIED OR DISCLOSED TO A THIRD PARTY WITHOUT THE WRITTEN CONSENT OF PANORAMA ANTENNAS LTD.				
© 2016			A4	